

LL33.17

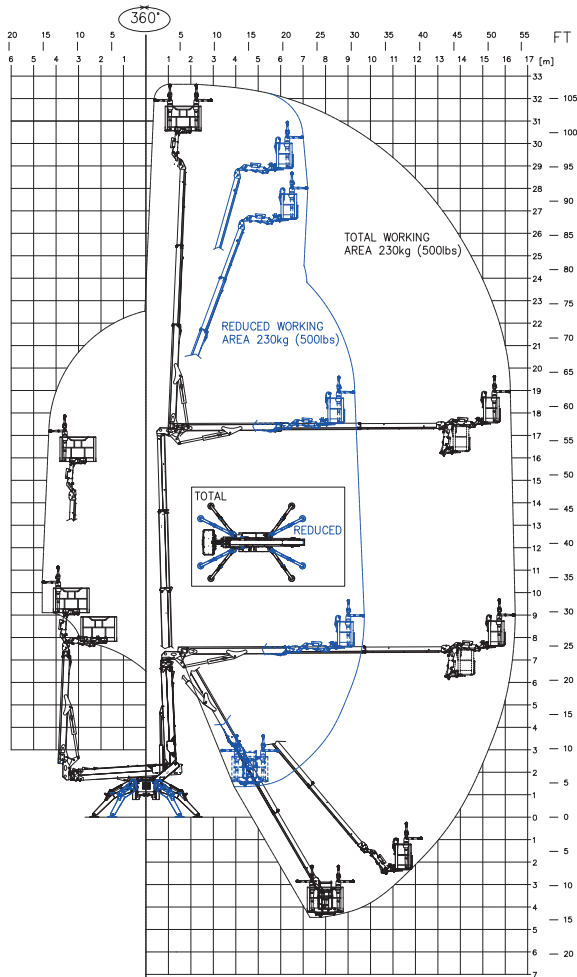

**CAPACITY 230 KG**  
(2 persons 80x2=160 kg + tool box 70 kg)

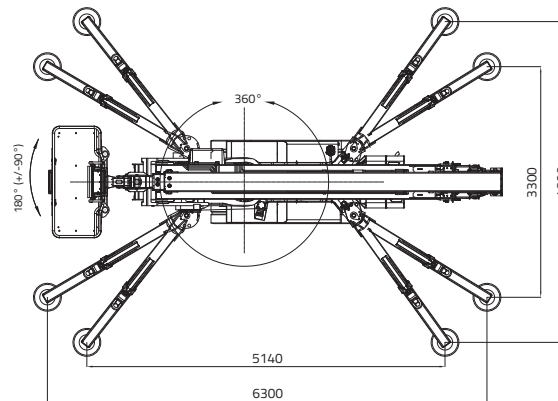
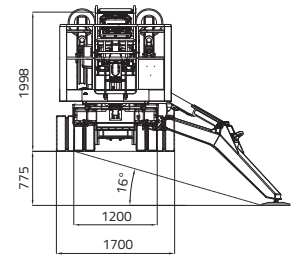
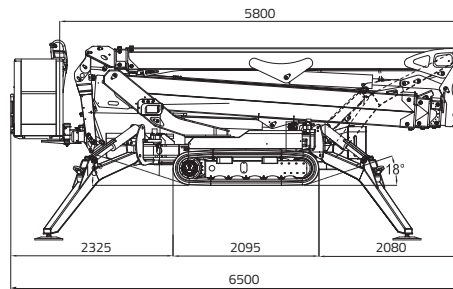

 32,60 m

 16,50 m

 6,50 m

 5,80 m

 1,99 m

 1.600 x 700 x h. 1.100 mm

 180° (+/-90°)

 16° / 28,7%

 1.200 / 1.700 mm

 5.000 daN - 4 daN/cm<sup>2</sup>

 Variable stabilization area:  
4.600 x 5.140 mm (total)  
3.300 x 6.300 mm (narrow)

 Automatic set up system IIIS std.

 Remote control

 GPRS-GPS

 R.A.H.M.

 Lithium-ion battery pack  
7,6 kWh - Optional

 Bi-energy (Diesel + Lithium-ion  
battery pack) - Optional



**DIESEL ENGINE**

Brand.....KUBOTA  
 Type .....D902 Autorev  
 Pistons no. and displacement..... 898 cm<sup>3</sup>  
 Max gross power .....  
 ..... 21,6 HP - 16,1 kW @ 3200 rpm  
 Electrical start..... 12 volt

**LITHIUM-ION SYSTEM**

Lithium-ion powered..... 7,6KWh  
 Onboard battery charger .....  
 ..... 220V or 110V+-30V 50-60 Hz  
 Autonomy ..... 4-5 h  
 Recharge time on flat batteries .....  
 ..... 4 h (indicative)  
 Recharge time to 80% on flat batteries.....  
 ..... 2 h (indicative)

**HYDRAULIC PUMPS**

Electric motor ..... no. 2 gear pumps

**TRACKED UNDERCARRIAGE**

Track tensioner ..... grease-filled  
 Rollers no. per side ..... 6 + slide

Translation speed with 2<sup>nd</sup> auto2speed:

- diesel engine ..... 0,8 - 1,8 km/h  
 - lithium system..... 0,6 - 1,3 km/h

WEIGHT MACHINE diesel engine..... 7700 kg  
 WEIGHT MACHINE lithium system ..... 7740 kg  
 WEIGHT MACHINE bi-energy ..... 7860 kg

MAX WIND SPEED ..... 12,5 m/s